

## CONCEPTUAL DRAWING

### Typical Wiring MilliAMP through Pressure Switch and Starter to Submersible Pump

**Note:** There are various suitable wiring methods. This represents what we feel is one of the most common applications.

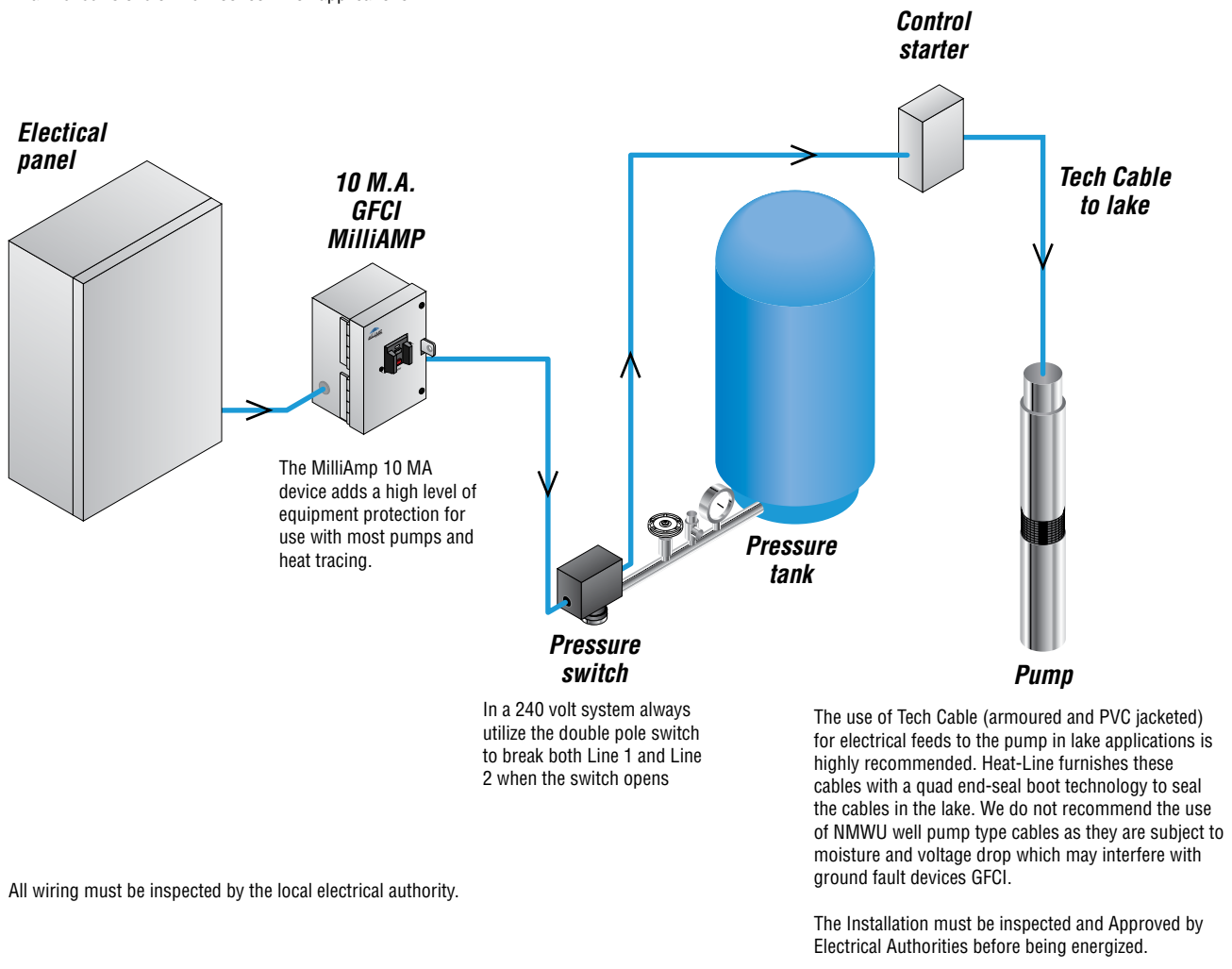

Heat-Line is a registered trademark of Heat-Line Corporation.

**Heat-Line**  
**A Division of Christopher MacLean Ltd.**

1095 Green Lake Road  
Carnarvon, ON  
Canada K0M 1J0  
Tel: (705) 754-4545  
(800) 584-4944  
Fax: (705) 754-4567  
info@heatline.com  
[www.heatline.com](http://www.heatline.com)

**Important:** All information, including illustrations, is believed to be reliable. Users, however, should independently evaluate the suitability of each product for their particular application. Heat-Line a Division of Christopher MacLean Ltd. makes no warranties as to the accuracy or completeness of the information, and disclaims any liability regarding its use. Heat-Line's only obligations are those in the Heat-Line Standard Terms and Conditions of Sale for this product, and in no case will Heat-Line be liable for any incidental, indirect, or consequential damages arising from the sale, resale, use, or misuse of the product. Specifications are subject to change without notice. In addition, Heat-Line reserves the right to make changes—without notification to Buyer—to processing or materials that do not affect compliance with any applicable specification.